



INNER REAL ESTATE

NEXTRE



4710/1 Queensbridge Street Southbank VIC

1 1

****ARRANGE AN INSPECTION TIME ONLINE - DETAILS BELOW****

View : <https://www.innerrealestate.com.au/lease/vic/inner-city/southbank/residential/apartment/6138576>

Situated in the heart of Melbourne's inner Southbank precinct this apartment comprises of an open plan living/dining, king sized bedroom with ample built-in-robos and a king size bed, large en-suite with dual vanity bowls with marble top, separate walk in shower and separate bath tub. The contemporary kitchen is completed with marble bench tops and quality stainless steel appliances. Enjoying other features that include ducted heating and cooling, contemporary bathroom with modern fixings, access to the sky lounge, pool, gym and 24-hour concierge, you're provided with all the amenities necessary to thrive in this prime location. In close proximity to Melbourne CBD, the Queen Victoria Gardens, Arts precinct, and Flinders Street station, you'll be hard-pressed



Izabella Frattezi Ramos
0418 511 885

<https://www.innerrealestate.com.au>

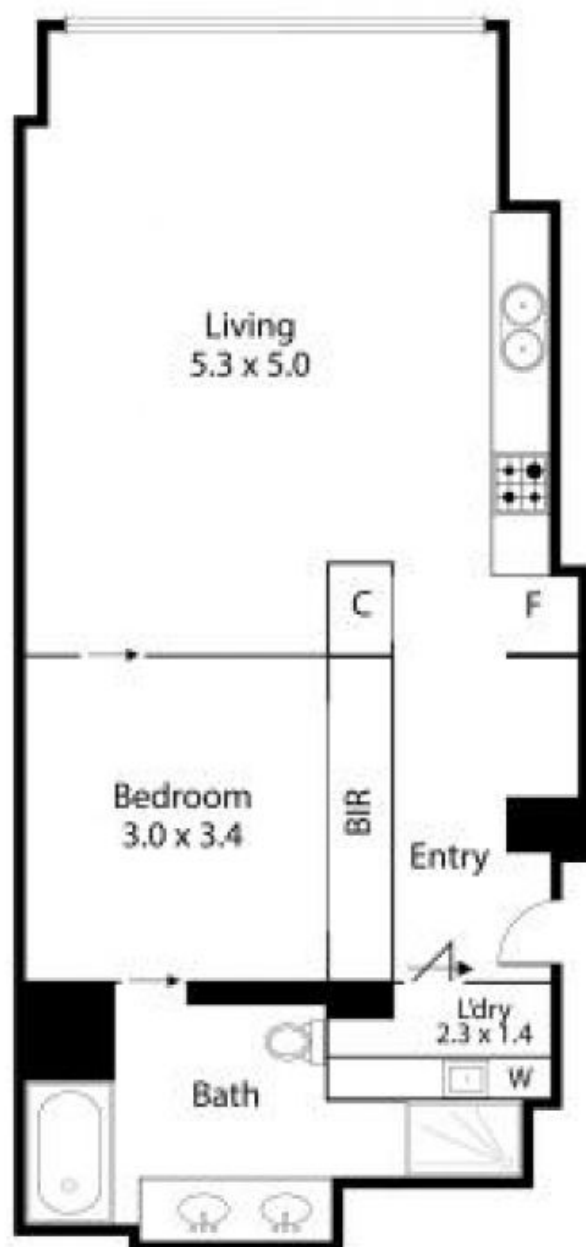

Every care has been taken to verify the correctness of details in this property plan. The plan is a representation only and is not necessarily to scale.