



INNER REAL ESTATE

NEXTRE



2802/265 Exhibition Street Melbourne VIC

2 2 1

****ARRANGE AN INSPECTION TIME ONLINE - DETAILS BELOW****

Located on the 28th floor of the Melbourne CBD's iconic Regency Towers, this very impressive two-bedroom apartment with one car space reflects a confident interpretation of ultra-convenient inner-city living. Included here is a roll call of resort-inspired residents' facilities including a fully-equipped gym, huge indoor heated pool, spa and sauna located on the top floor, while this dress circle address places you just moments from some of the city's most celebrated restaurants, cafes, shopping, Treasury and Carlton Gardens.

Inside, plush carpet anchors open-plan living and dining as a neutral interior palette showcases your assured sense of style. Adding flexibility to the home's fabulous form, an

View : <https://www.innerrealestate.com.au/lease/vic/inner-city/melbourne/residential/apartment/6138609>



Izabella Frattezi Ramos
0418 511 885

<https://www.innerrealestate.com.au>

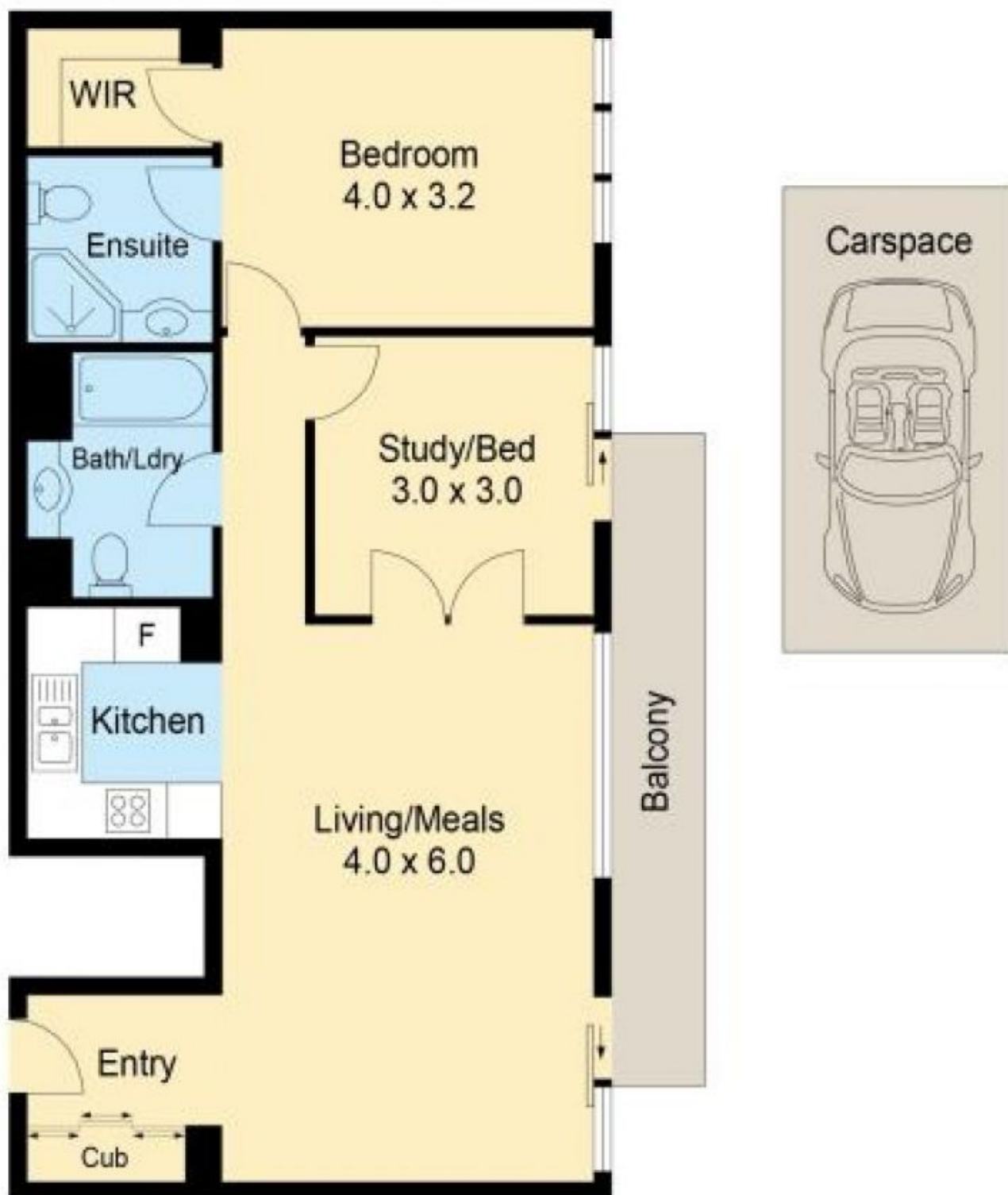

ALL INFORMATION CONTAINED HEREIN IS GATHERED FROM SOURCES WE BELIEVE TO BE RELIABLE. HOWEVER WE CANNOT GUARANTEE ITS ACCURACY AND INTERESTED PERSONS SHOULD RELY ON THEIR OWN ENQUIRES. DIMENSIONS ARE APPROXIMATE.