



83/632 St Kilda Road Melbourne VIC

3 2 1

Backdropped by a spectacular Port Phillip Bay vista, this deluxe apartment in The Boulevarde is your dress-circle invitation to city living.

Positioned high above one of Melbourne's most iconic boulevards, this is where city convenience and nature unite, with the lush green display of Albert Park's lakeside precinct below.

This spacious 3-bedroom, 2-bathroom domain is sized to excite, with a secure car park and access to resort-style facilities including two pools, a tennis court and landscaped gardens.

Ever-changing views are yours to savour by day and night, with cruise and container ships passing on the horizon, Junction Oval in the foreground, the St Kilda and Middle Park landscape beyond and the rim of the bay in the distance.

The open-plan living and dining space gazes over this

**Price** : \$ 865,000

**View** : <https://www.innerrealestate.com.au/sale/vic/inner-city/melbourne/residential/apartment/6139020>

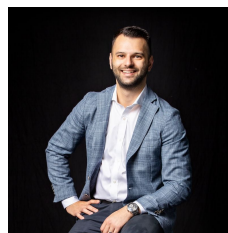

**Anthony Cimino**  
+61 3 9804 5551



**Jonathan Mallas**  
+61 3 9804 5551

# Melbourne

83/632 St Kilda Road

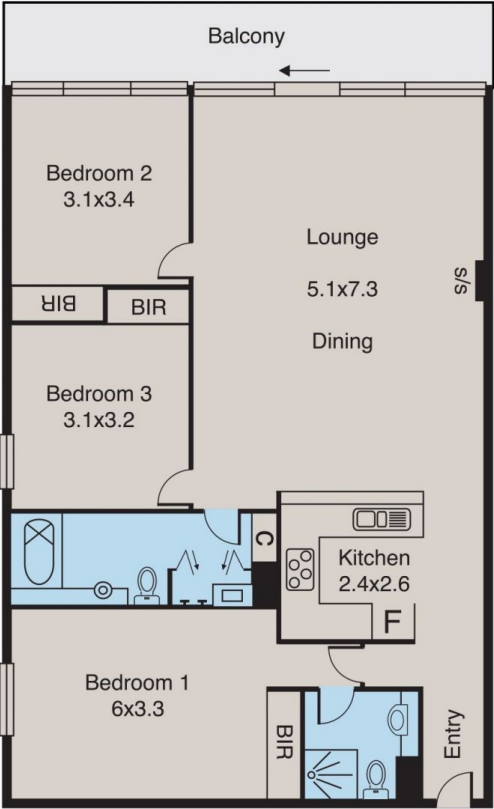

ALL INFORMATION CONTAINED HERE IN IS GATHERED FROM SOURCES WE BELIEVE TO BE RELIABLE. HOWEVER WE CANNOT GUARANTEE ITS ACCURACY AND INTERESTED PERSONS SHOULD RELY ON THEIR OWN ENQUIRIES. DIMENSIONS ARE APPROXIMATE.