



# INNER REAL ESTATE NEXTRE



**410/64 Macaulay Road North Melbourne VIC**

2 1 1

Opposite the North Melbourne Football Ground in the exclusive Pumhouse complex, this impressive top-floor apartment presents an idyllic city-fringe lifestyle with its generous design, quality features and elevated outlook.

**View** : <https://www.innerrealestate.com.au/lease/vic/inner-city/north-melbourne/residential/apartment/6139332>

Freshly painted and new floor boards with a storage room on the same floor. The light-filled interior comprises two double bedrooms (both with robes) and modern central bathroom, open living/dining area leading out to an undercover terrace to enjoy the views. Add to this a stone-bench kitchen with Blanco appliances, split-system heating and cooling, European laundry, video intercom, plus lift to entry foyer and undercover parking space.



**Kayani Shahzeb**  
**+61 3 9804 5551**

All within walking distance to supermarket, North Melbourne Recreation Centre, Abbotsford Street trams, Errol Street cafes and shops, close to North Melbourne

<https://www.innerrealestate.com.au>

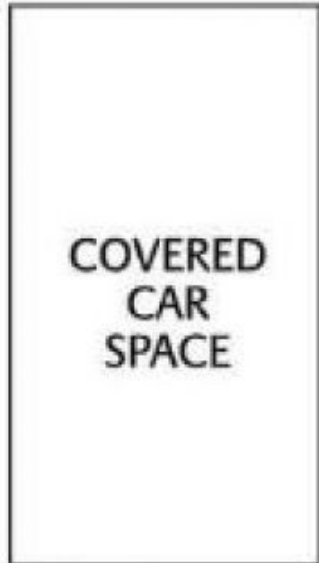
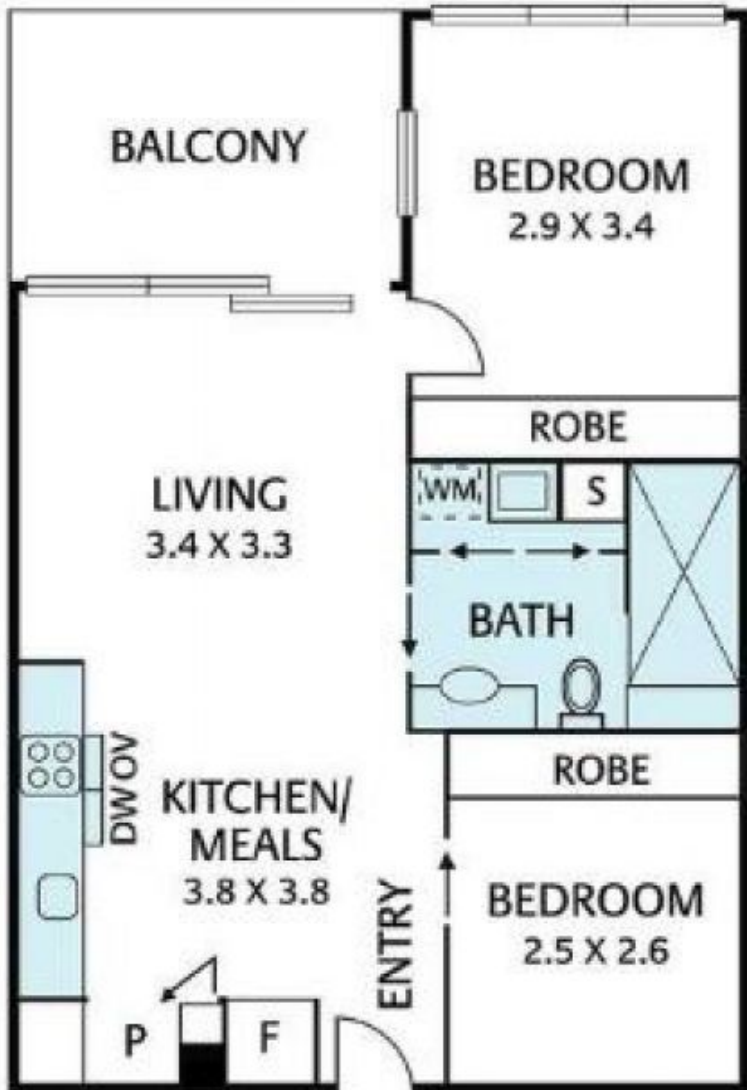

(NOT IN POSITION)