



INNER REAL ESTATE NEXTRE



1017/555 St Kilda Road Melbourne VIC

2 2 1

This stunning south-east facing apartment features an open plan living and dining which is overlooked by a kitchen equipped with top Miele appliances. Floor-to-ceiling windows invite the outdoors in to the spacious open plan living space, with dual views heightening the sense of luxury.

Featuring:

- Generous floorplan approx. 104 sqm and a spacious balcony of 22 sqm approx further expands the living areas
- Secure parking space with extra storage
- Both bedrooms with built-in robes; master with ensuite
- Sweeping 180 degree views offer picturesque views of the bay, and allow abundant sunlight to flow in all day long.
- Additional features include discrete laundry facilities, heating and cooling, intercom access and a secure car park

View : <https://www.innerrealestate.com.au/lease/vic/inner-city/melbourne/residential/apartment/6361084>



Jordan Bracegirdle
0428 967 571



Kayani Shahzeb
+61 3 9804 5551



PARQUE

MELBOURNE

2 BED + 2 BATH

TYPE D13

0817, 0917, 1017, 1117, 1217, 1317, 1417, 1517

Internal area 82.00m²

Balcony area 22.00m²

Total area 104.00m²

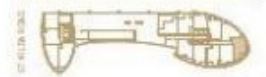

Setia
Melbourne



FRANK KATRALIN ARCHITECTS

This plan and any areas shown may be subject to the terms of the contract and the design is subject to change to suit final building drawings, grid lines and existing requirements. The area of apartment has been measured to the boundaries of the floor and where a boundary intersects a wall or glass line and includes any other. All dimensions are approximate.