

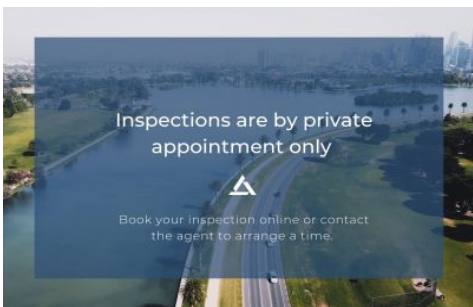

# INNER REAL ESTATE NEXTRE



**1604/594 St Kilda Road Melbourne VIC**

1 1 1

Boasting sophistication and unrivalled location, this north-facing 1-bedder situated within the acclaimed "Alto on the Boulevard" building provides a leafy-lifestyle on the city fringe. Moments from Albert Park Lake, Fawkner Park, St Kilda Road trams, and Prahran's vibrant nightlife, this apartment offers a premier lifestyle on an iconic Melbourne boulevard.

**Price** : \$379,000

**View** : <https://www.innerrealestate.com.au/sale/vic/inner-city/melbourne/residential/apartment/6362120>

- ? Generous main bedroom with built-in-robos
- ? Bright and open living space with reverse cycle heating and air conditioning
- ? Modern galley kitchen featuring SMEG appliances and stone benchtops
- ? Bathroom with European laundry
- ? Secure building and lift access with on-site building manager and concierge
- ? Indoor, heated 25 meter lap pool, fully equipped

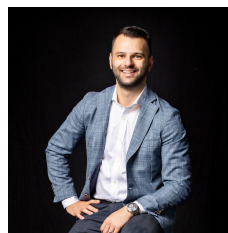

**Anthony Cimino**  
+61 3 9804 5551



**Jonathan Mallas**  
+61 3 9804 5551

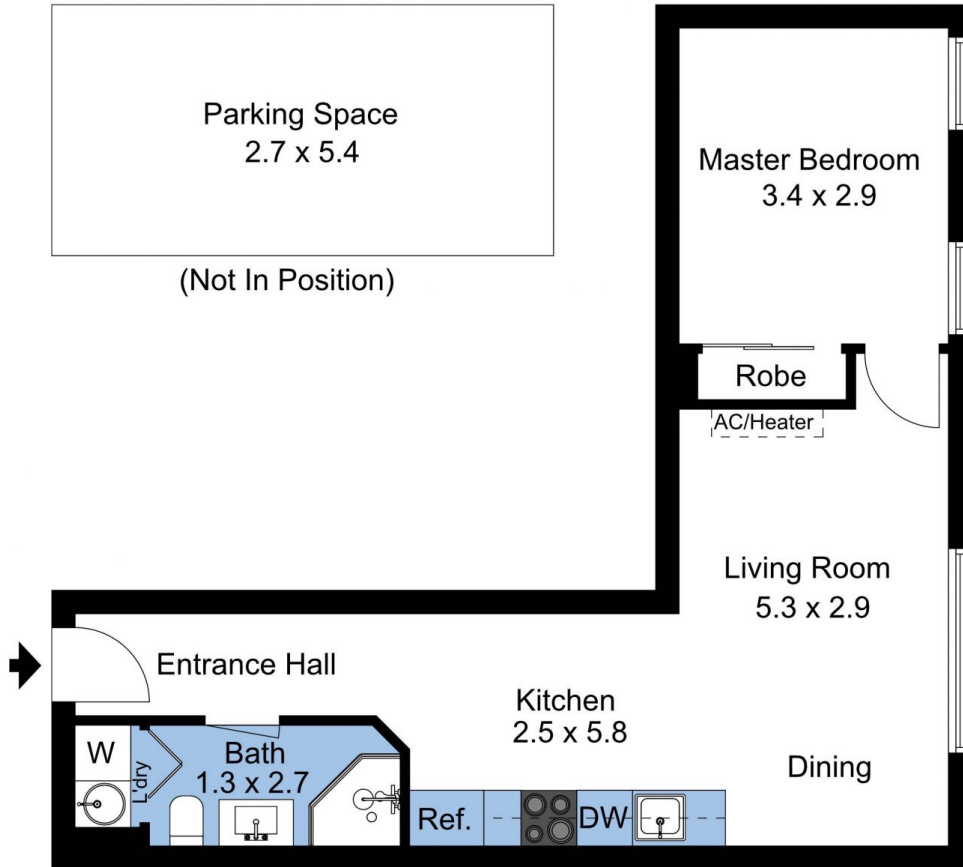

The floor plan is not to scale, measurements are indicative and in metres. Exterior elements are not in position. Plans should not be relied on. Interested parties should make and rely on their own enquiries.