

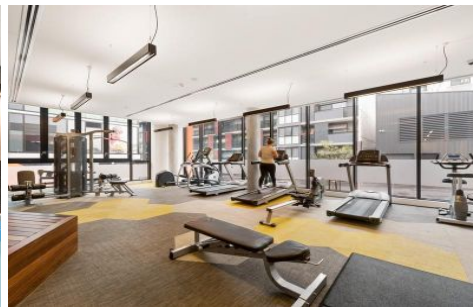

INNER REAL ESTATE NEXTRE



B804/8 Grosvenor Street Abbotsford VIC

2 1 1

Capturing the essence of inner city cool on the cusp of Richmond, footsteps from Vibrant Victoria Street and the banks of the Yarra River, this stylish designer apartment has been crafted for effortless contemporary living. Impeccably appointed throughout, it showcases a bright open plan design complemented by premium security and impressive residents' facilities. It has city trams at the door and is placed just a short stroll to Victoria Gardens Shopping Centre, North Richmond station, riverside parklands and a host of cosmopolitan restaurants and bars.

* Spacious light filled living and dining area, sunny balcony
* Stunning modern kitchen with stainless steel gas appliances

* Two double sized bedrooms including mirrored built-in robes

* Sleek bathroom that has full height tiles and a walk-in shower

View : <https://www.innerrealestate.com.au/lease/vic/inner-city/abbotsford/residential/apartment/6763792>



Kayani Shahzeb
+61 3 9804 5551

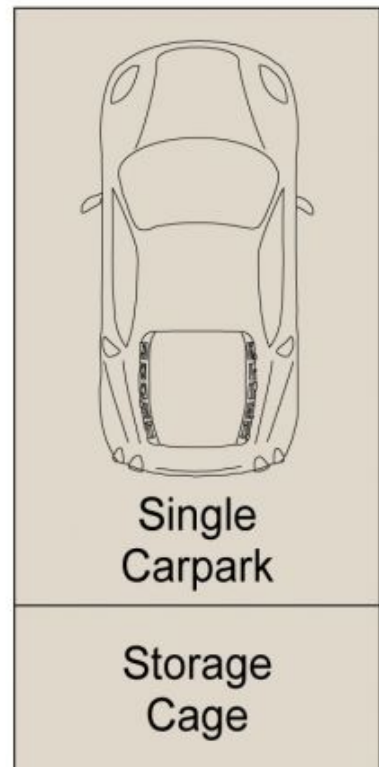
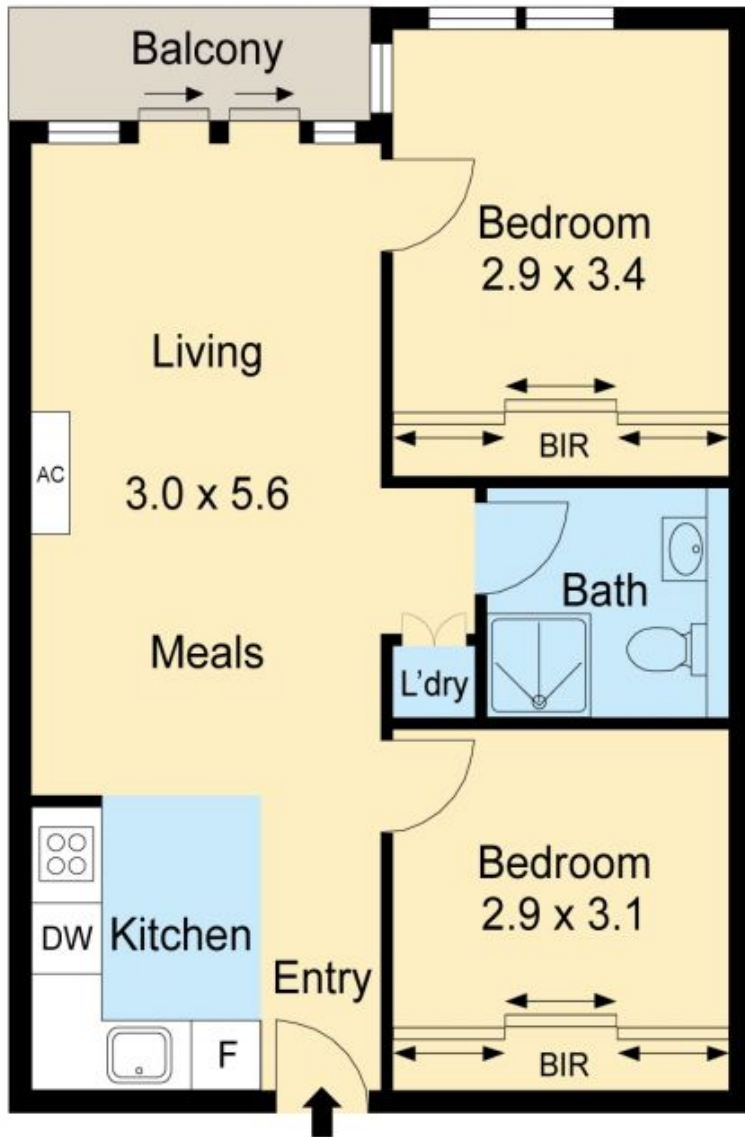

ALL INFORMATION CONTAINED HERE IN IS GATHERED FROM SOURCES WE BELIEVE TO BE RELIABLE. HOWEVER WE CANNOT GUARANTEE ITS ACCURACY AND INTERESTED PERSONS SHOULD RELY ON THEIR OWN ENQUIRES. DIMENSTIONS ARE APPROXIMATE.