



1602/568 St Kilda Road Melbourne VIC

3  2  1 

With views across the verdant Fawcner Park and the playing fields of Melbourne's prestigious Wesley College, this impressive three-bedroom Rhapsody apartment couples sustainable style with sophisticated inner-city living on one of the world's best-loved boulevards. A dazzling design by award-winning architect Karl Fender offers a superb balance of leading-edge luxury and environmental sustainability, while this dress circle destination places you within effortless reach of the CBD, cosmopolitan St Kilda and the serene sanctuary of Albert Park Lake. The complex itself has been designed to achieve low greenhouse emissions, while high-quality residents' amenities include a fully-equipped gym, meeting room, fashionable lobby and the added convenience of a ground floor cafe.

Type : Apartment

Price : \$990,000

View : <https://www.innerrealestate.com.au/sale/vic/inner-city/melbourne/residential/apartment/8317690>

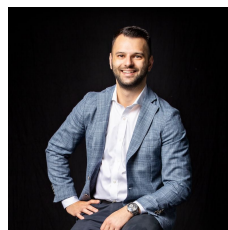

Anthony Cimino
+61 3 9804 5551



Matt Kunz
+61 3 9804 5551

[For full version visit the website](https://www.innerrealestate.com.au)

<https://www.innerrealestate.com.au>

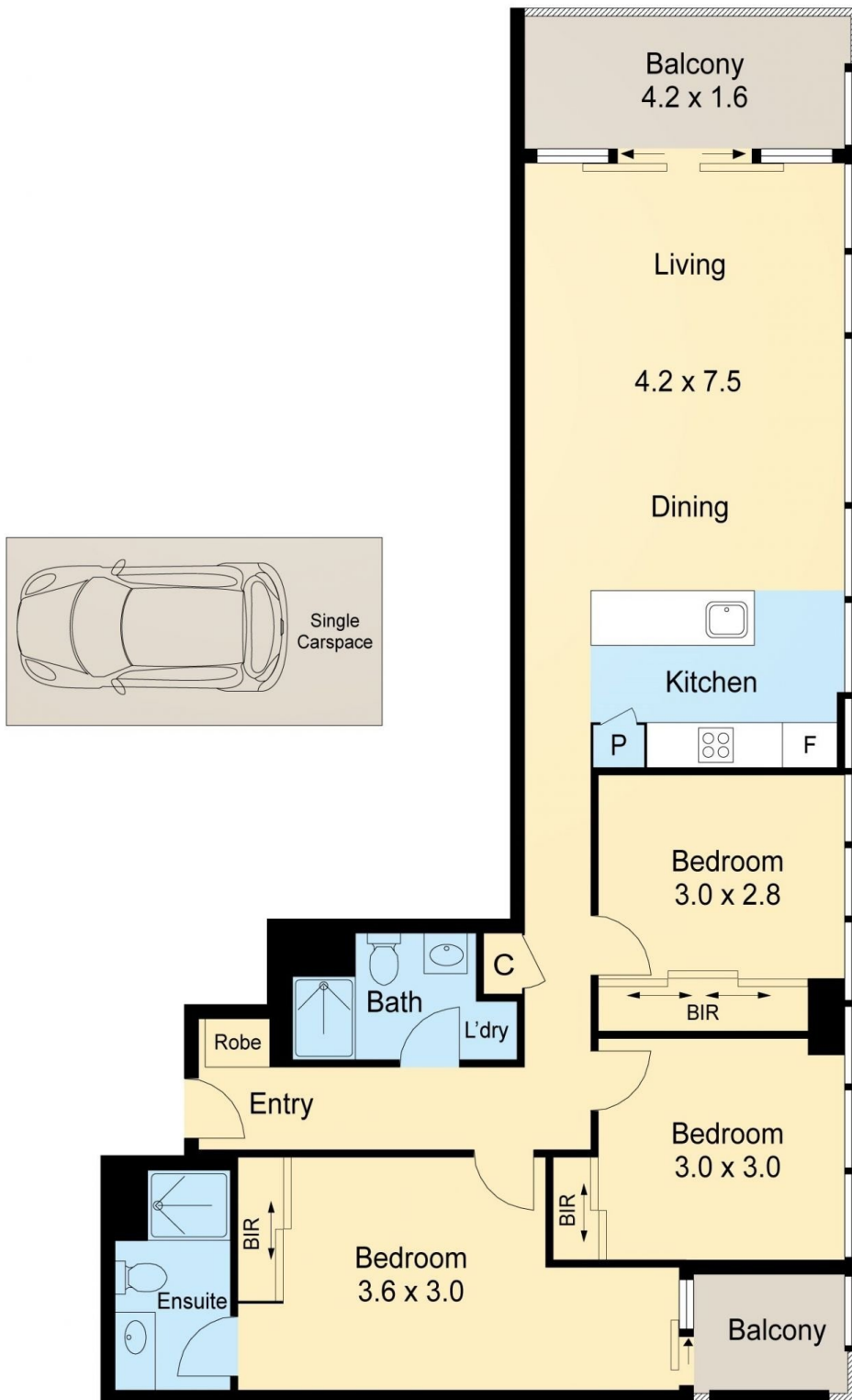

ALL INFORMATION CONTAINED HERE IN IS GATHERED FROM SOURCES WE BELIEVE TO BE RELIABLE. HOWEVER WE CANNOT GUARANTEE ITS ACCURACY AND INTERESTED PERSONS SHOULD RELY ON THEIR OWN ENQUIRES. DIMENSIONS ARE APPROXIMATE.