

INNER REAL



1003/280 Spencer Street Melbourne VIC

1  1  1 

Located at the ever-popular west-end of Melbourne's buzzing CBD is this smart and stylish entry level pad! Located in Mondriane Tower and tailor-made for first time buyers and those who want to secure an appealing city investment, this 1-bedroom apartment has an array of exciting modern hallmarks.

This property is located on the 10th floor and will be an absolute cinch to maintain. A long entry hallway extends into the carpeted living and meals zone, which further opens out to the charming undercover balcony. Incorporated into the living space is the sleek kitchen which has timber floors underfoot, as well as the advantage of stone benchtops and stainless steel appliances. As part of the Mondriane, you'll also have enviable access to a

Type : Apartment

Price : \$320,000 - \$350,000

View : <https://www.innerrealestate.com.au/sale/vic/inner-city/melbourne/residential/apartment/8683325>



Anthony Cimino
+61 3 9804 5551



Gio Campagnaro
+61 3 9804 5551

[For full version visit the website](https://www.innerrealestate.com.au)

<https://www.innerrealestate.com.au>

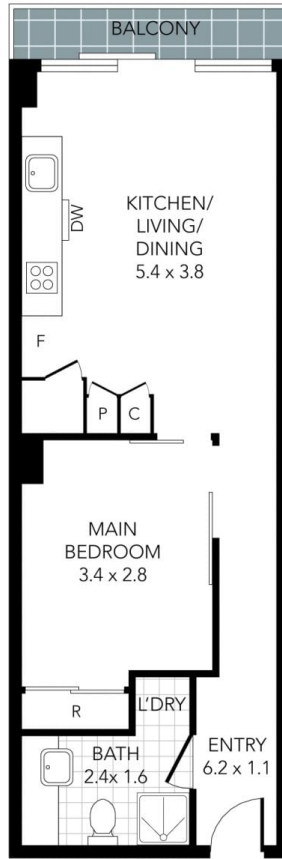
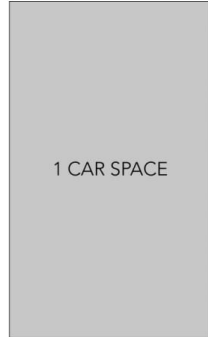

Internal Area: 43m²

THIS PLAN IS NOT TO SCALE. MEASUREMENTS ARE INDICATIVE AND IN METRES. SITE PLAN REFLECTS APPROXIMATE POSITION OF BUILDINGS ON PROPERTY ONLY AND IS NOT AN ACCURATE REPRESENTATION OF VEGETATION AND OTHER EXTERNAL LANDSCAPE FEATURES. THIS PLAN SHOULD NOT BE RELIED UPON AND INTERESTED PARTIES SHOULD MAKE THEIR OWN ENQUIRIES.